

† Loctite # 271, available as part # 851325 Loctite 271 Packet.

N70CCB

Coil-Fed Pneumatic Nailers

Clavadoras Neumáticas Alimentadas Por Rollo

Cloeurs Pneumatiques À Enroulement

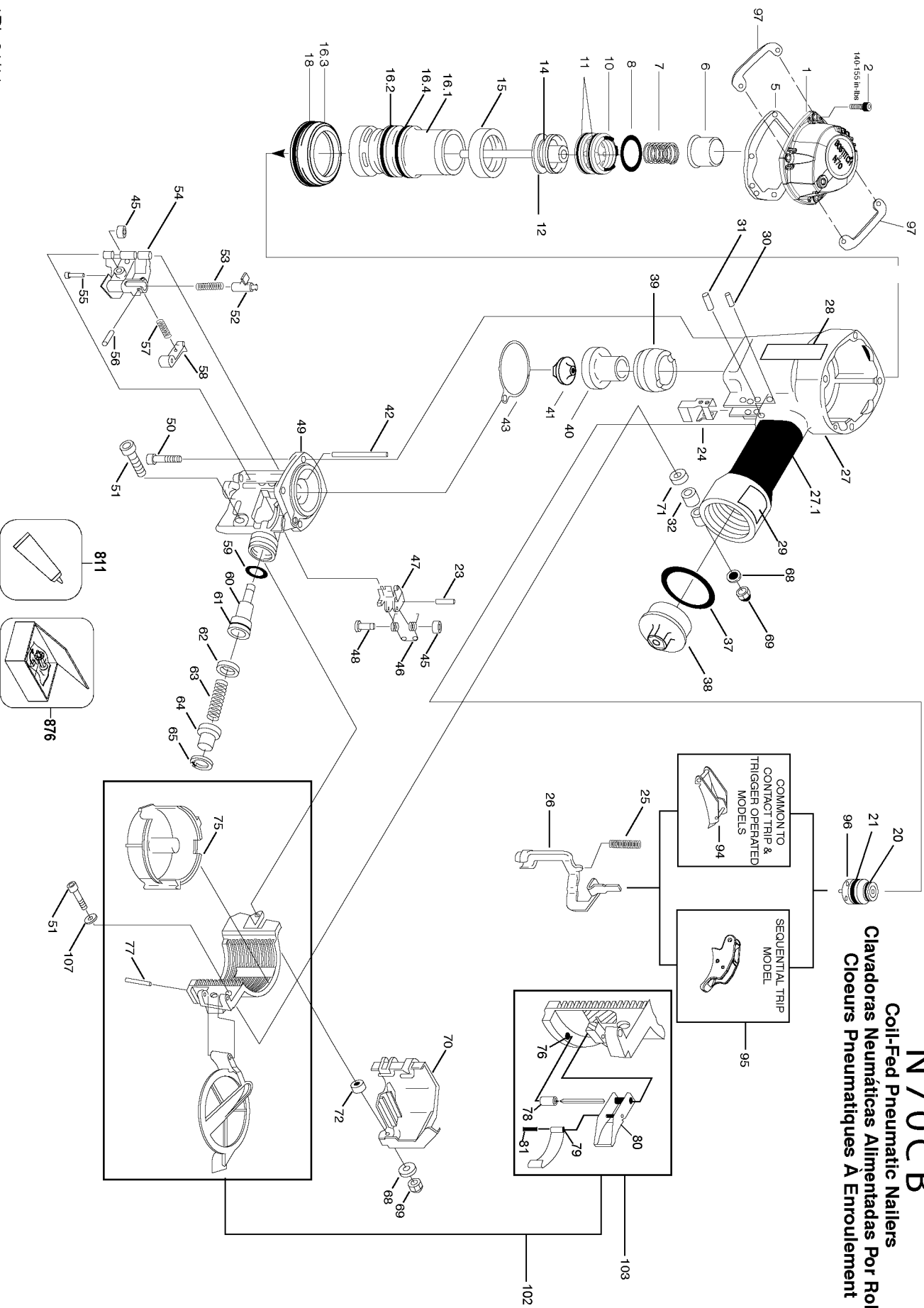

IP1088-1RL 01/11
 TO BE USED WITH PARTS LIST IP1088-2 AND OPERATION AND MAINTENANCE MANUAL 103947.

Parts List for N70CB-1 Type 0

Item Number	Part Number	Description	Qty Required
1	CN31652	CAP-CYLINDER	1
2	MSC6100-30	SCREW-SHCS-M6X1.00X3	4
5	N70118	SEAL-CYLINDER CAP	1
6	N70153	PISTON STOP	1
7	101256	SPRING-COMPRESSION	1
8	MRG041630	O-RING-1.638X.118	1
10	N80337	HEAD VALVE PISTON	1
11	851438	O-RING-2.236X.115	2
12	102630	ASSEMBLY-DRIVER/PIST	1
14	851439	O-RING-1.689X.190	1
15	N70155	SEAL-CYLINDER	1
16	N70171	SLEEVE-CYLINDER	1
16	N80169	SEAL-CHECK	1
16	N80168	RING-CYLINDER	1
16	101236	O-RING-2.48X.115	1
18	MRG084431	O-RING-3.323X.122	1
20	86459	O-RING	1
21	MRG019824	O-RING-.780X.094	1
23	MPP030016	PIN-SPIRAL-M3X16	1
24	N70145	GUIDE-ARM	1
25	102080	SPRING-COMPRESSION	1
26	N70168	ARM CONTACT FLARED	1
27	110005	FRAME	1
27	000000-00	No Longer Available	1
28	112767	LABEL-BOSTITCH	1
29	159912	LABEL-WARNING-COIL N	1
30	MPP030020	PIN-SPIRAL M3X20MM	1

Parts List for N70CB-1 Type 0

Item Number	Part Number	Description	Qty Required
31	102549	PIN-SPECIAL SPIROL M	1
32	N70143	BUSHING-RUBBER	1
37	MRG049431	O-RING-2.343X.118	1
38	N70167	CAP-END	1
39	N70156	BUMPER - A	1
40	N70157	BUMPER - B	1
41	N80130	DRIVER GUIDE	1
42	N70164	PIN-SPECIAL	1
43	107834	SEAL-NOSE	1
45	854004	WASHER-RUBBER-7	1
46	854023	SPRING-TORSION	1
47	167087	PAWL-FEED	1
48	N50087	PIN-SPECIAL(STEP)	1
49	167086	NOSE	1
50	MSC8125-28	SCREW-SHCS M8X28	4
51	MSC6100-40	SCREW-SOC. HD. CAP M	1
52	N70150	LATCH DOOR	1
53	101408	SPRING-COMPRESSION	1
54	N70122	DOOR	1
55	N70140	PIN-SPECIAL(STEP)	1
56	MPP030012	PIN-SPIROL	1
57	854011	COMPRESSION SPRING	1
58	N70149	PAWL CHECK	1
59	MRG009824	O-RING-.386X.094	1
60	N70166	FEED PISTON	1
61	851437	O-RING-.819X.095	1
62	N70162	STOP-FEED PISTON	1

Parts List for N70CB-1 Type 0

Item Number	Part Number	Description	Qty Required
63	854039	SPRING-COMPRESSION	1
64	N70163	SPRING COLLAR	1
65	MRB026	RETAINING RING- METR	1
68	MPW6.2	WASHER.SPECIAL	1
69	MHE6100-100	NUT-ESN M6X1	1
70	N70160	GUARD	1
71	N80107	SPACER-FRAME	1
72	105973	SPACER	1
75	N80103	BOTTOM-CANISTER	1
76	UB2126	PIN-ROLL 1/8 X 1 5/8	1
77	UB5130	PIN-SPIROL 1/4 X 1 7	1
78	N80106	SPACER-LATCH	1
79	N80108	SPRING-FLAT	1
80	107455	LATCH-CANISTER	1
81	UB2110.4	PIN-ROLL 1/8 X 5/8	1
94	CNTK2	KIT-CONTACT TRIP CON	1
95	SEQ6	KIT-SEQUENTIAL	1
96	TVA6	KIT-TRIGGER VALVE	1
97	102473	PROTECTOR-TOP FRAME	2
102	121635	ASSEMBLY-CANISTER	1
103	121632	ASSEMBLY-BRACKET	1
107	MPW6.3	WASHER-PWN M6	1
811	851325	LOCTITE	1
876	RBK8	N70/N80/N90 REBUILD	1